

## Product Information Vacuum Change Over C 2006

### Continuous Gas Supply

Dangerous gases enter the line system with negative pressure by default. At least two gas containers are needed for a continuous gas supply. Once the first gas container is empty the C2006 vacuum change over switch automatically switches to the second gas container. It facilitates an uninterrupted supply.

Vacuum change over switches are used in swimming pools, water works, for water purification processes and in the most diverse applications.

### Completely independent

The C2006 can be used for chlorine gas, hydrogen chloride, carbon dioxide or sulphur dioxide. It uses the negative pressure already present in the line system and works without auxiliary power. The C2006 switches between two gas supplies without intervention from the personnel and with the utmost reliability. If the supply from the first gas container fails, the negative pressure increases and C2006 switches over to the second gas container.

The C2006 is also designed to operate through collecting pipes with several gas containers. Different connections for the line system are available as optional.

### Symmetrical design

The C2006 is used line systems supplied with negative pressure. Both inlets that stem from the gas container are separated from each other by a mobile membrane. The pressure ratio between the two inlets changes abruptly when the first gas container is completely emptied. If the pressure ratio at the membrane is outweighed in favour of the second, still full gas container, then the C2006 switches over by moving the membrane. Magnetic surfaces keep the membranes in position.

The switching point can be adjusted if necessary. A switch over can be made manually at any time with the C2006.

### In short

- Scope of application with chlorine gas up to 10 kg/hr
- For chlorine gas, hydrogen chloride, carbon dioxide or sulphur dioxide
- Compact design
- Safe operation with vacuum technology
- Without auxiliary power
- Without intervention from personnel
- Simple wall mounting



### Technical data

Flow rate with chlorine gas	up to 10 kg/hr
Connections	G 3/4 a (PVC, DN10)
Connection set for hoses (optional)	8/12 and 12/16
Dimensions (W x H x D)	210 x 95 x 90 mm
Weight	approx. 1.8 kg

## Product Information Vacuum Change Over C 2006

### Model variant

Product	Output	Connections	Order no.
Vacuum change over switch C 2006	up to 10 kg Cl <sub>2</sub> /hr	G 3/4 a	20410000

### Dimensional figure

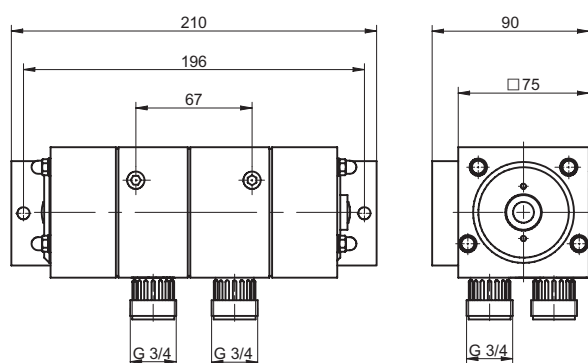

All dimensions in mm

### Accessories

The following accessories are available as optional for its installation and operation:

Description	Order no.
Connection set for hose 8/12	35441
Connection set for hose 12/16	35442
Box spanner to adjust the switching function	31631
Manometer, -1...0 bar, to adjust the switching function with connections for PE-hose 8/12	32245
Maintenance set (small): Membrane, stopper, O-rings	35512
Maintenance set (large): Membrane, stopper, O-rings, compression springs and valve bellows	35513